

# THERMOCOUPLE ISOLATED TEMPERATURE HEAD TRANSMITTER THT202-I



The Tekon Electronics Thermocouple Isolated Temperature In Head Transmitters are specifically designed to meet the most rigorous requirements of operation in the industrial process environments.

The THT202-I is a temperature transmitter which accepts exclusively thermocouples temperature sensors and generates a linear 4 to 20mA current signal with high stability as output.

**Dimensions** 45Ø x 23 mm

**Weight** Approx. 50g

**Material** Nylon 66

**Protection Index** IP40

## KEY FEATURES

### THERMOCOUPLE SENSOR INPUT

J, K, N, R, S, T

### WIDE MEASUREMENT RANGE

### 1,5 kV AC GALVANIC ISOLATION

### 4 TO 20 mA ANALOG OUTPUT

### 2 STATUS LEDS

### HIGH MEASUREMENT ACCURACY

### HIGH EMC PERFORMANCE

### NAMUR NE 43 FAULT COMPLIANT

### CONFIGURABLE OVER PC

TEKON CONFIGURATOR SOFTWARE

DS\_INHD\_THT202-I-E01B

**TECHNICAL SPECIFICATIONS**

**INPUT  
THERMOCOUPLES (TC)**

Measured variable	Temperature
Sensor type	Thermocouples: J, K, N, R, S, T
Units	°C
Connection	1 Thermocouple (TC)
Sensor current diagnostic	<11 nA
Open-circuit monitoring	Always active (cannot be disabled)
Short-circuit monitoring	Not available
Cold junction compensation (CJC)	Integrated resistance thermometer
Measuring range	Configurable (see table "Digital measuring accuracy")
Minimum measured span	50°C
Characteristic curve	Temperature-linear

**OUTPUT**

Output signal	4 to 20 mA
Power supply (Uaux)	12 to 24V DC
Max. load	$(U_{aux} - 12) / 0,021 A$
Error signal (e.g. following sensor fault) (conforming to NAMUR NE43)	Software configurable 3,2mA or 21mA
Sample cycle	< 200ms
Protection	Against reversed polarity Surge protection

**COMMON SPECIFICATIONS**

Isolation voltage (test   operation)	1,5 kV AC   48 V AC
Internal power dissipation	40 mW to 0,5 W
Voltage drop	12V DC
Effect of supply voltage variation	< 0,003% of span/ V DC
Response time 90%	< 1s
Power-up time	< 600ms

**MEASUREMENT ACCURACY**

Reference conditions	
Auxiliary power	24V DC ± 1%
Ambient temperature	23°C
Warm-up time	2 min
Error in the analog output (digital/analog converter)	≤ ± 0,01% of span
Digital measuring errors	See table "Digital measuring accuracy" table
Error due to internal cold junction	< ± 0,35 °C
Influence of ambient temperature	
on thermocouple	Thermocouples J, K, N: ≤ ± 0,0008 °C / °C Thermocouples R, S, T: ≤ ± 0,0012 °C / °C

on analog output	< ± 0,002% of span / °C
EMC - immunity influence (IEC 61326-1)	< ± 0,0891% of span
Extended EMC immunity (NAMUR NE 21, A criterion, burst)	< ± 0,63% of span

**OPERATING ENVIRONMENT**

Ambient temperature range	-40 to 80°C
Storage temperature range	-40 to 80°C
Relative humidity	≤95%, without condensation

**FACTORY DEFAULT SETTINGS**

Sensor	Thermocouple K
Measuring range	-270°C to 1372°C
Temperature Format	Celsius [°C]
Sensor fault signaling	3,2 mA
Current offset	0 μA

**CASING**

Material	Nylon 66
Weight	Approx. 50g
Dimensions	See "Dimensional drawings"
Cross section of cables	2.5 mm <sup>2</sup>
Protection type	IP40

**CERTIFICATES AND APPROVALS**

EN 61326-1 - Class B - Industrial Requirements
IEC 61000-4-2
IEC 61000-4-3
IEC 61000-4-4
IEC 61000-4-5
IEC 61000-4-6
IEC 61000-4-8

**DIGITAL MEASURING ACCURACY**

**THERMOCOUPLES (TC)**

SENSOR	RANGE °C	DIGITAL ACCURACY °C
J	-210 to 1200	< ± 0,5
K	-270 to 1372	< ± 0,5
N	-270 to 1270	< ± 0,5
R	-50 to 1768	< ± 1
S	-50 to 1768	< ± 1
T	-270 to 400	< ± 0,5

TECHNICAL DRAWINGS AND INFORMATION

DIMENSIONAL DRAWINGS & INSTALLATION DIAGRAM

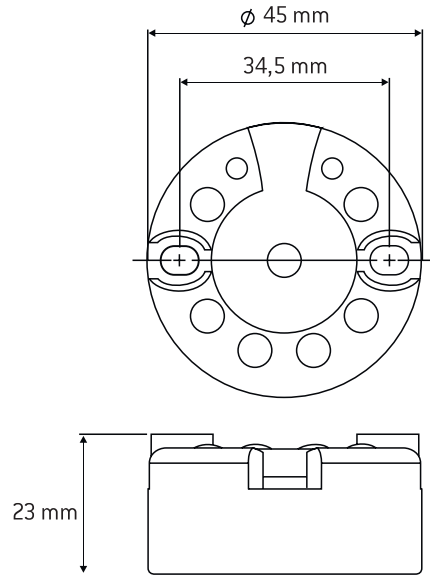

ELECTRICAL CONNECTIONS

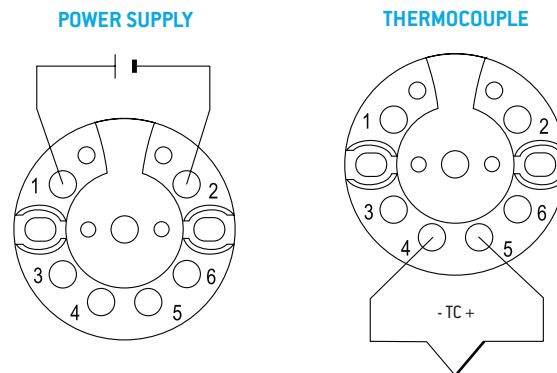

STATUS LED

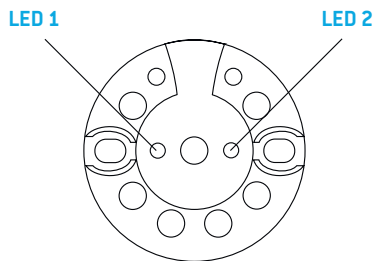

LED 1 (RED)	LED 2 (BLUE)	
OFF	BLINK	No sensor error Configuration mode
FLASH	BLINK	Sensor error Configuration mode
BLINK	BLINK	Temperature out of range Configuration mode
OFF	ON	No sensor error Normal mode
FLASH	ON	Sensor error Normal mode
BLINK	ON	Temperature out of range Normal mode

**BLOCK DIAGRAM**

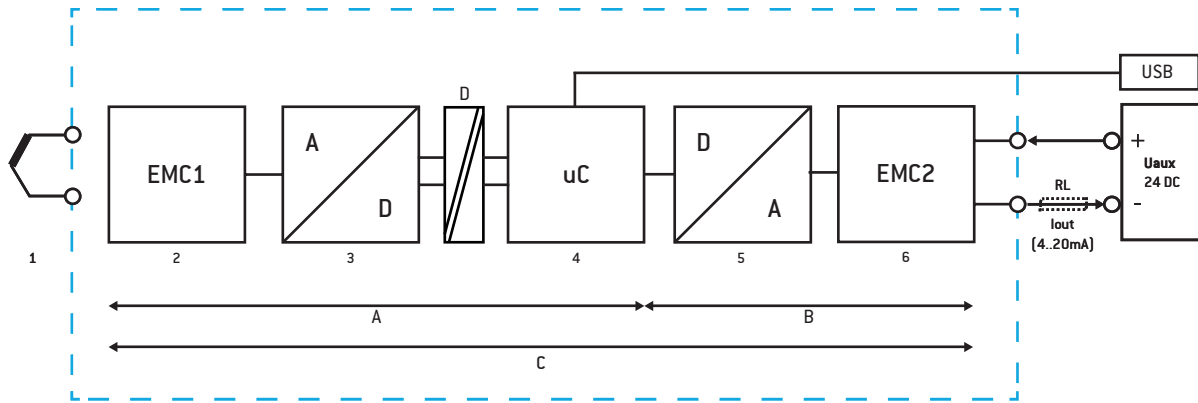

- 1 - Sensor (TC)
- 2 - Sensor input protection module
- 3 - Analog-Digital converter (16 Bits)
- 4 - Microcontroller
- 5 - Digital-Analog converter (16 bits)
- 6 - Output protection module

- RL - Loop load
- Uaux - Power supply
- Iout - Output current
- A - Digital measure accuracy
- B - Digital / Analog conversion accuracy
- C - Total measure accuracy
- D - Electrical isolation

**REVISION HISTORY**

**VERSION**

E01B Revision of "Isolation voltage" values.

TEKON ELECTRONICS  
a brand of Bresimar Automação S.A.

Quinta do Simão  
3800-230 Aveiro  
PORTUGAL

P.: +351 234 303 320  
M.: +351 933 033 250  
E.: sales@tekonelectronics.com

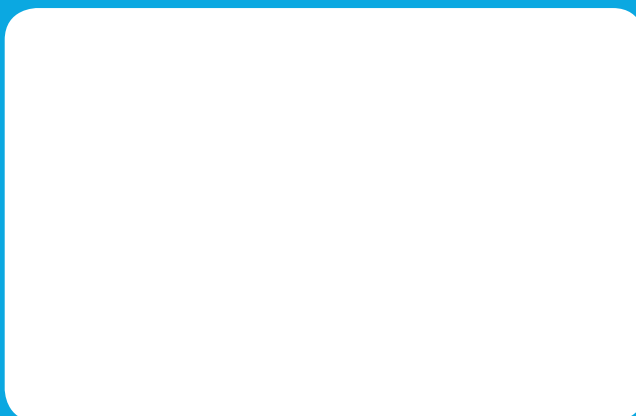

Cofinanciado por:



UNIÃO EUROPEIA  
Fundo Europeu  
de Desenvolvimento Regional